

43

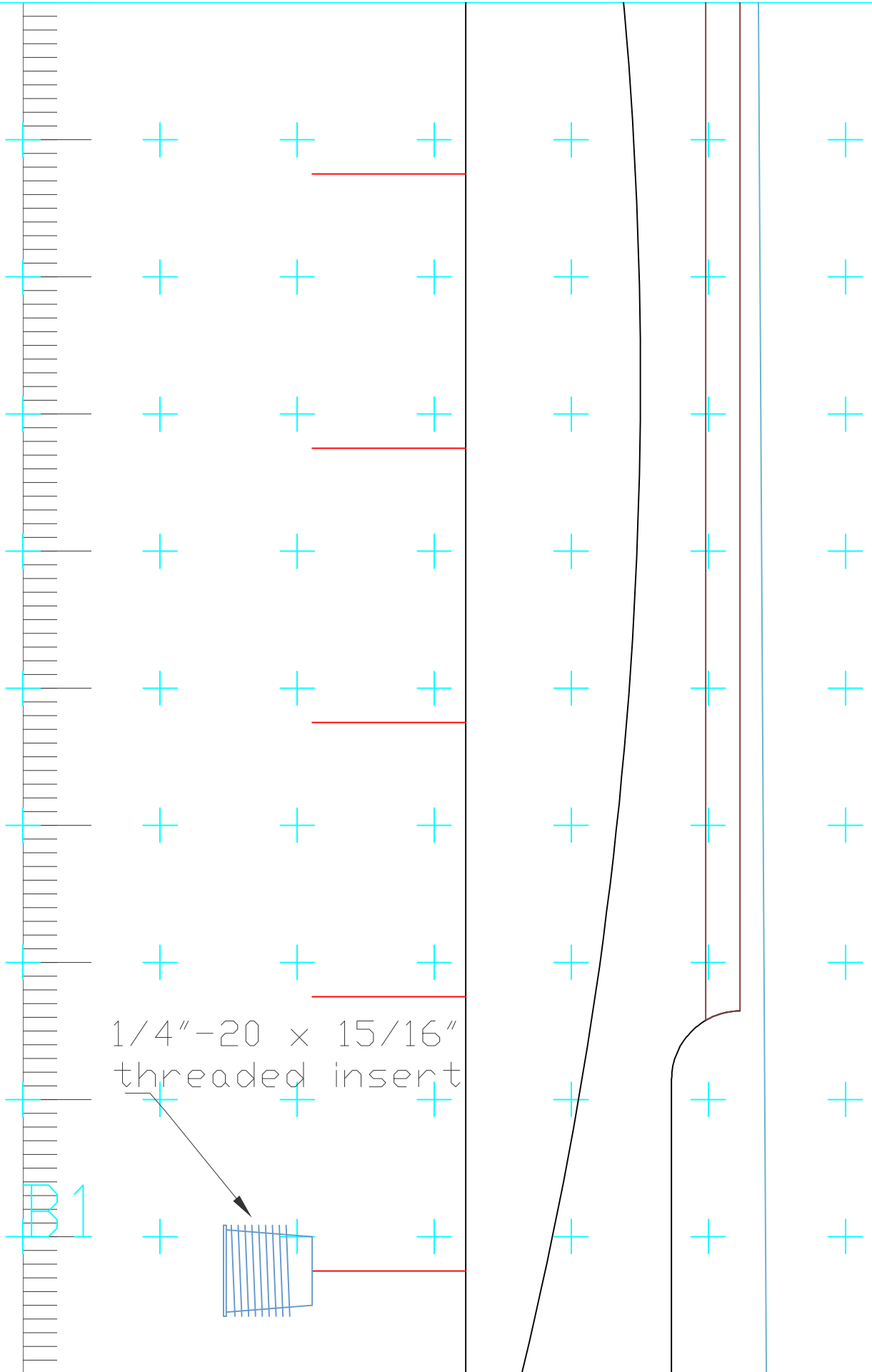

1/4"-20 x 15/16"
threaded insert

B1

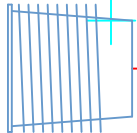

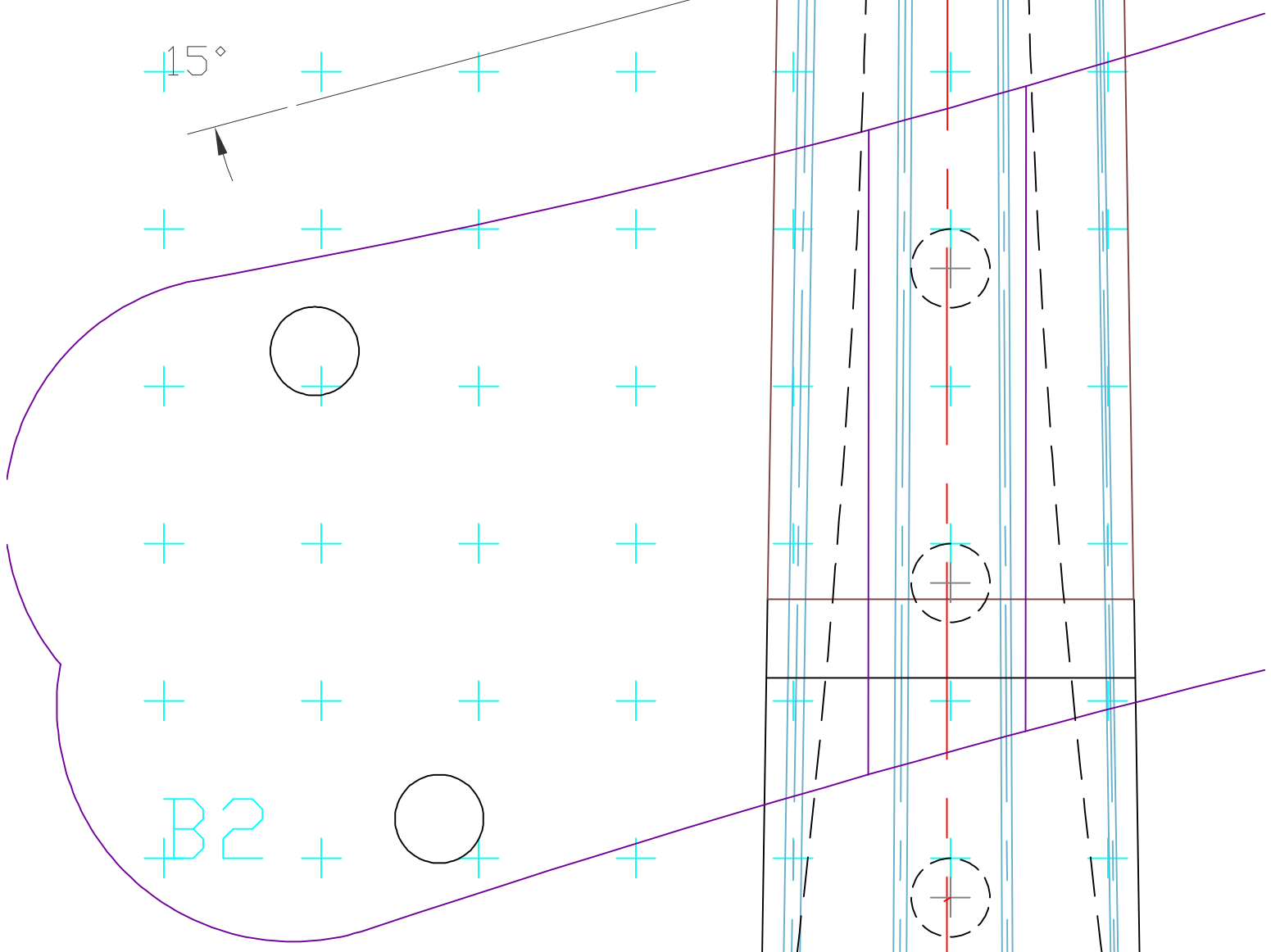
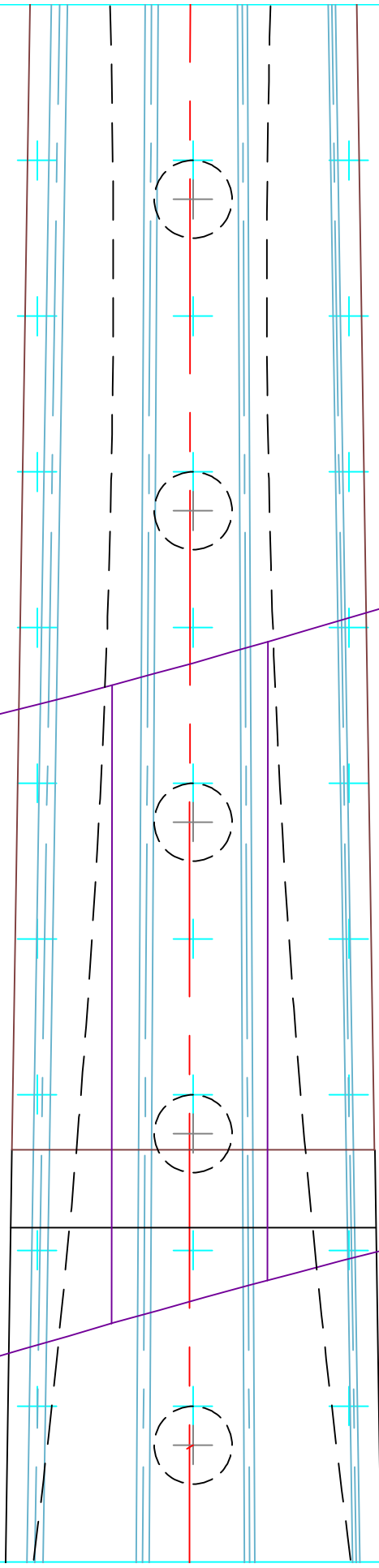
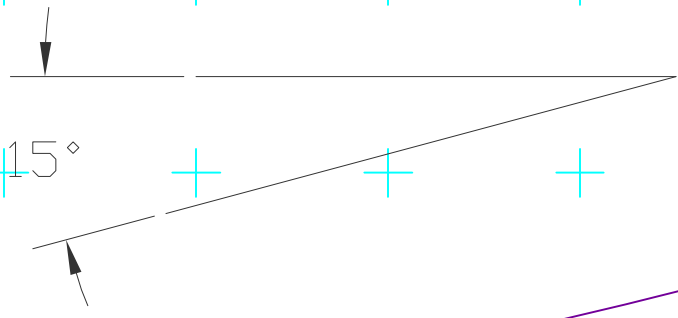
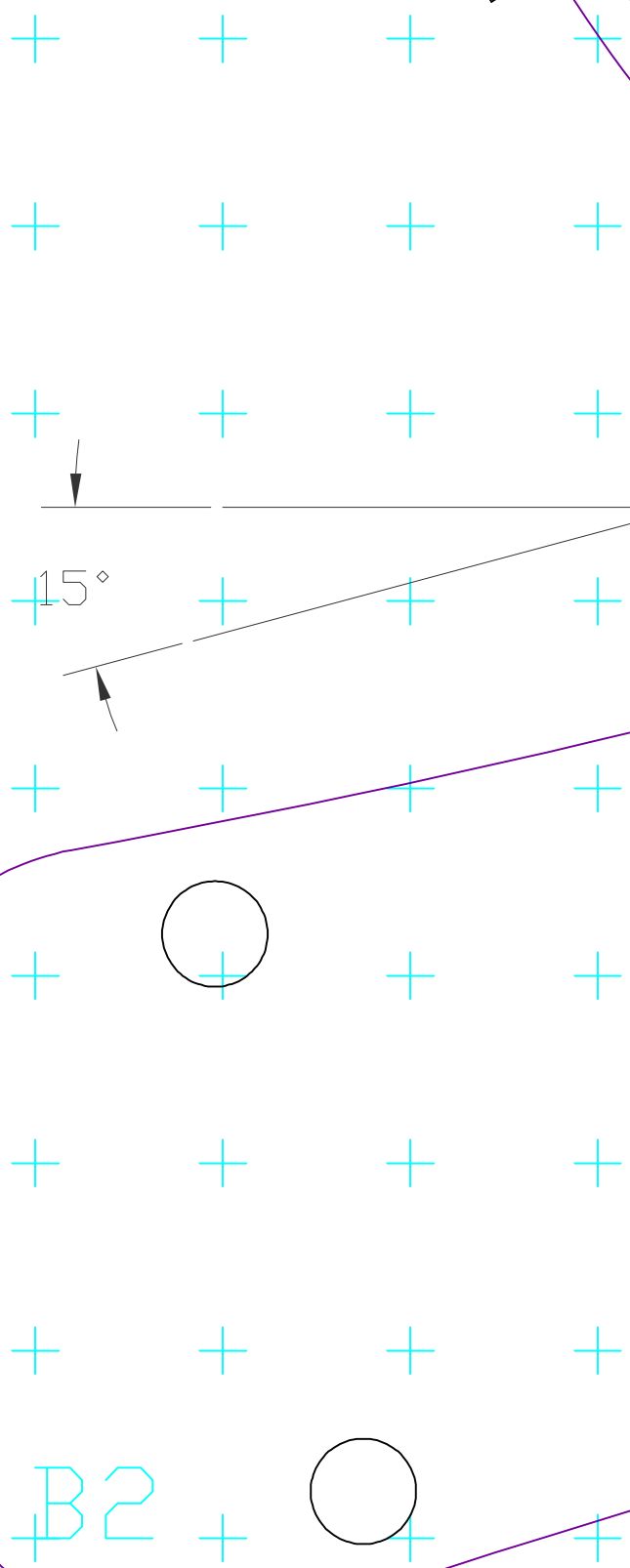
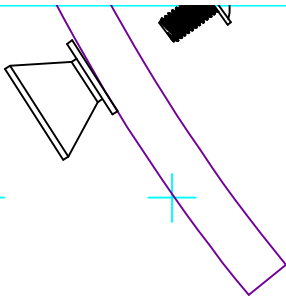

1" FH wood screw

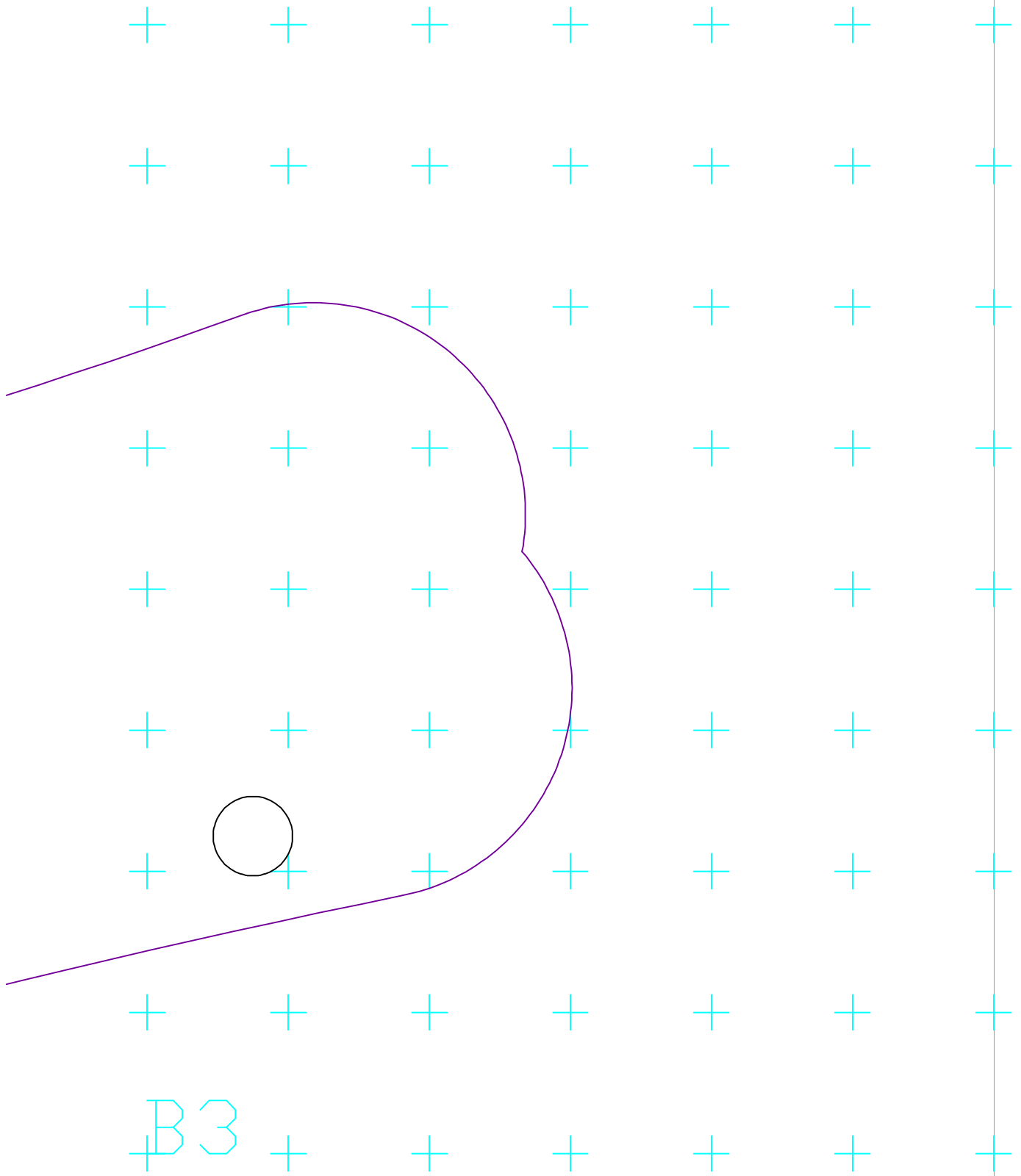

B3

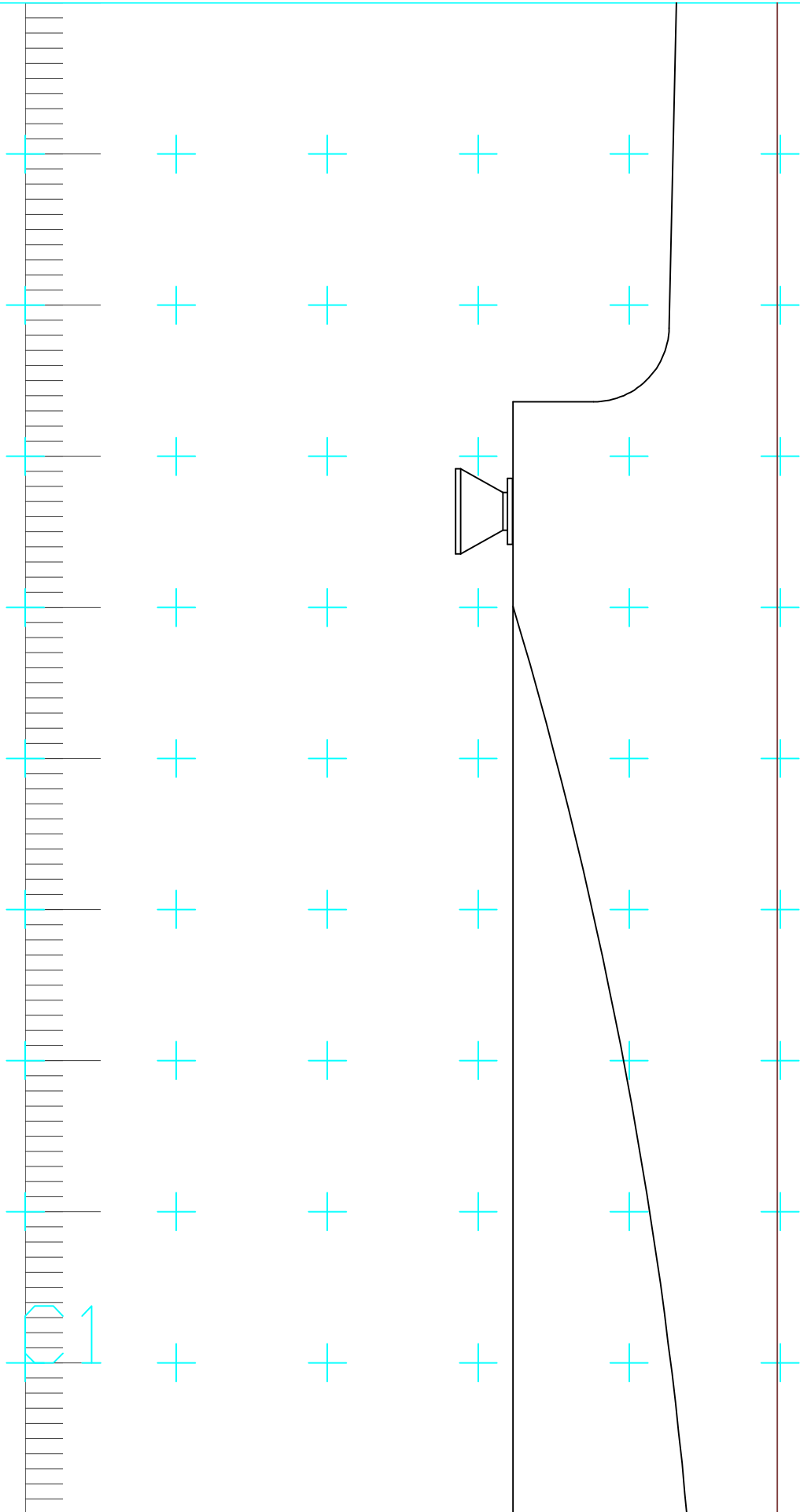

Wing (To
 Wing mo
 shown c
 parallel
 plane.
 to scal

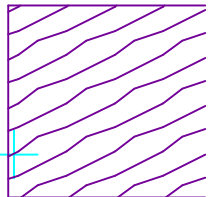

top view.
cutting block
is rotated
to the viewing
Wing not shown
e.)

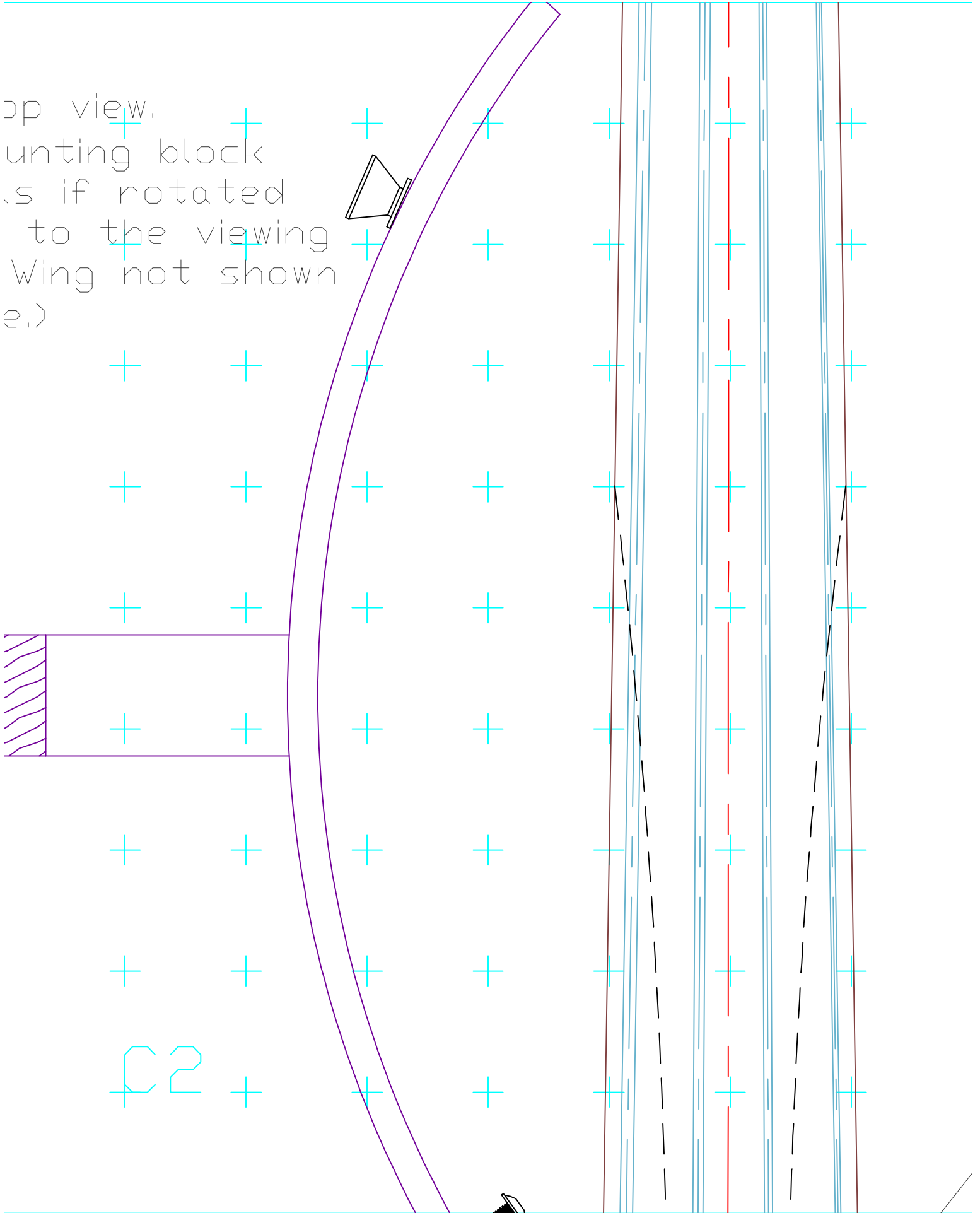

C2

Bridge Detail

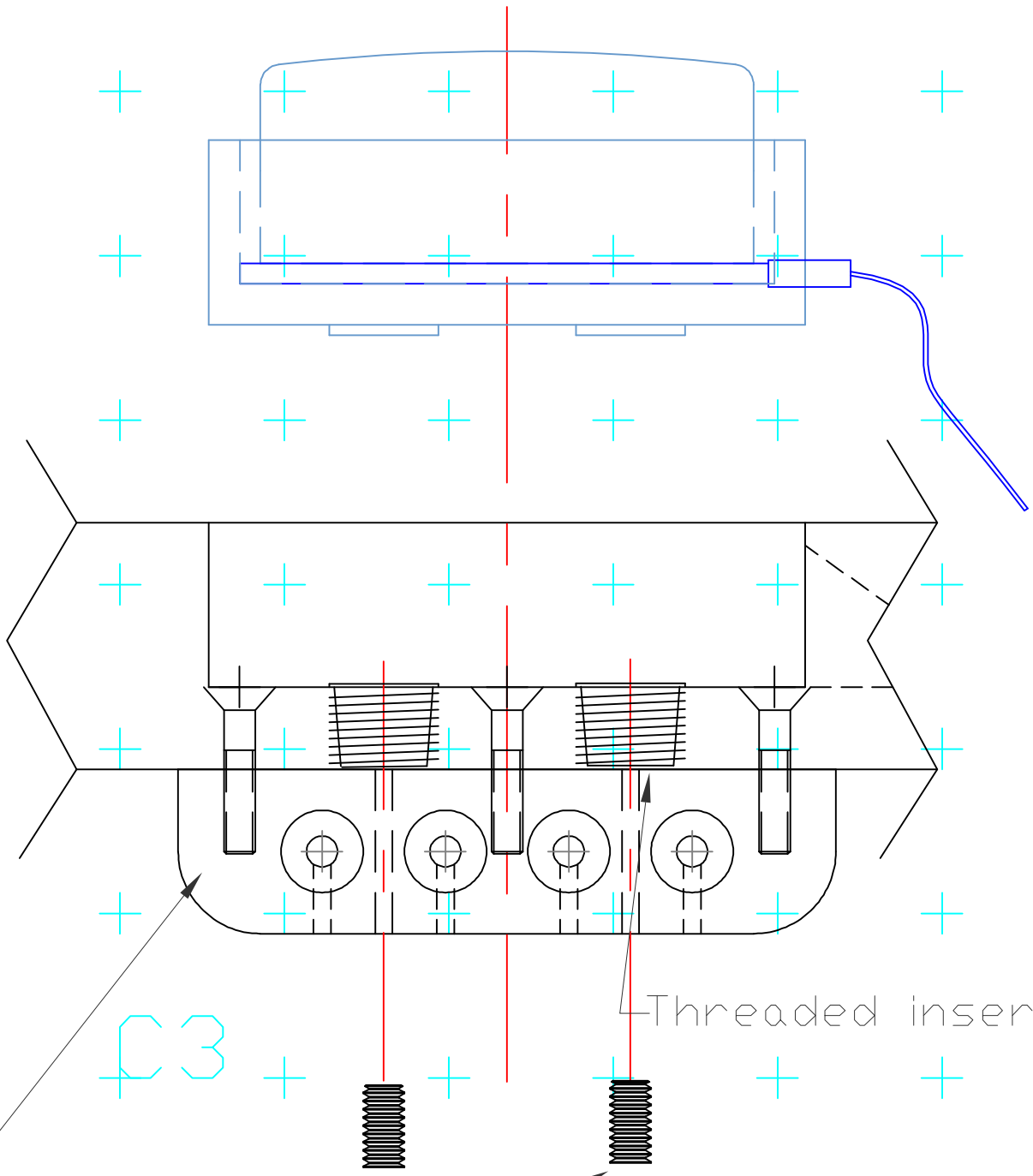

C3

Threaded insert

1/4 - 20 set screw

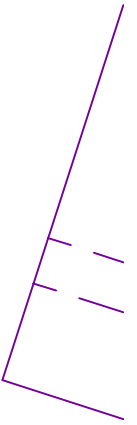
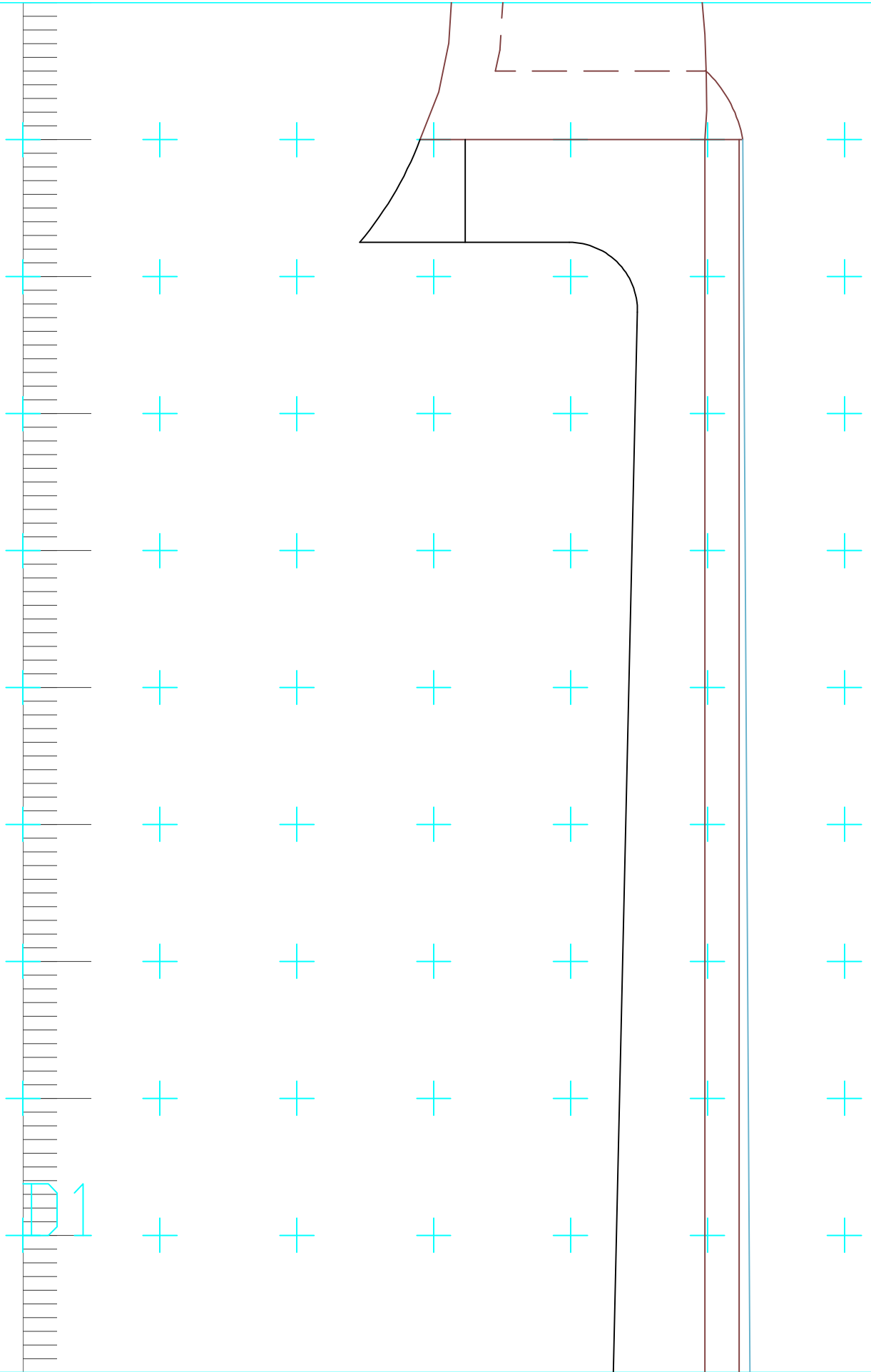

01

Wing (End view,
Wing mounting block
shown as if rotated
parallel to the viewing
plane. Wing not shown
to scale.)

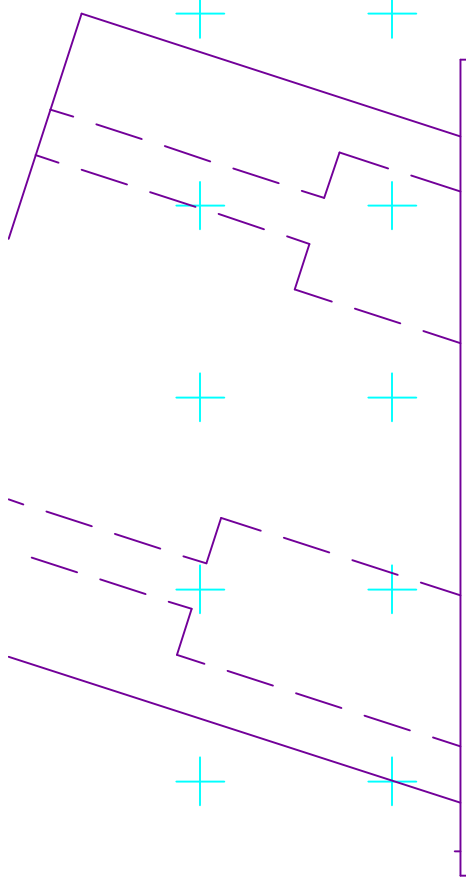

D2

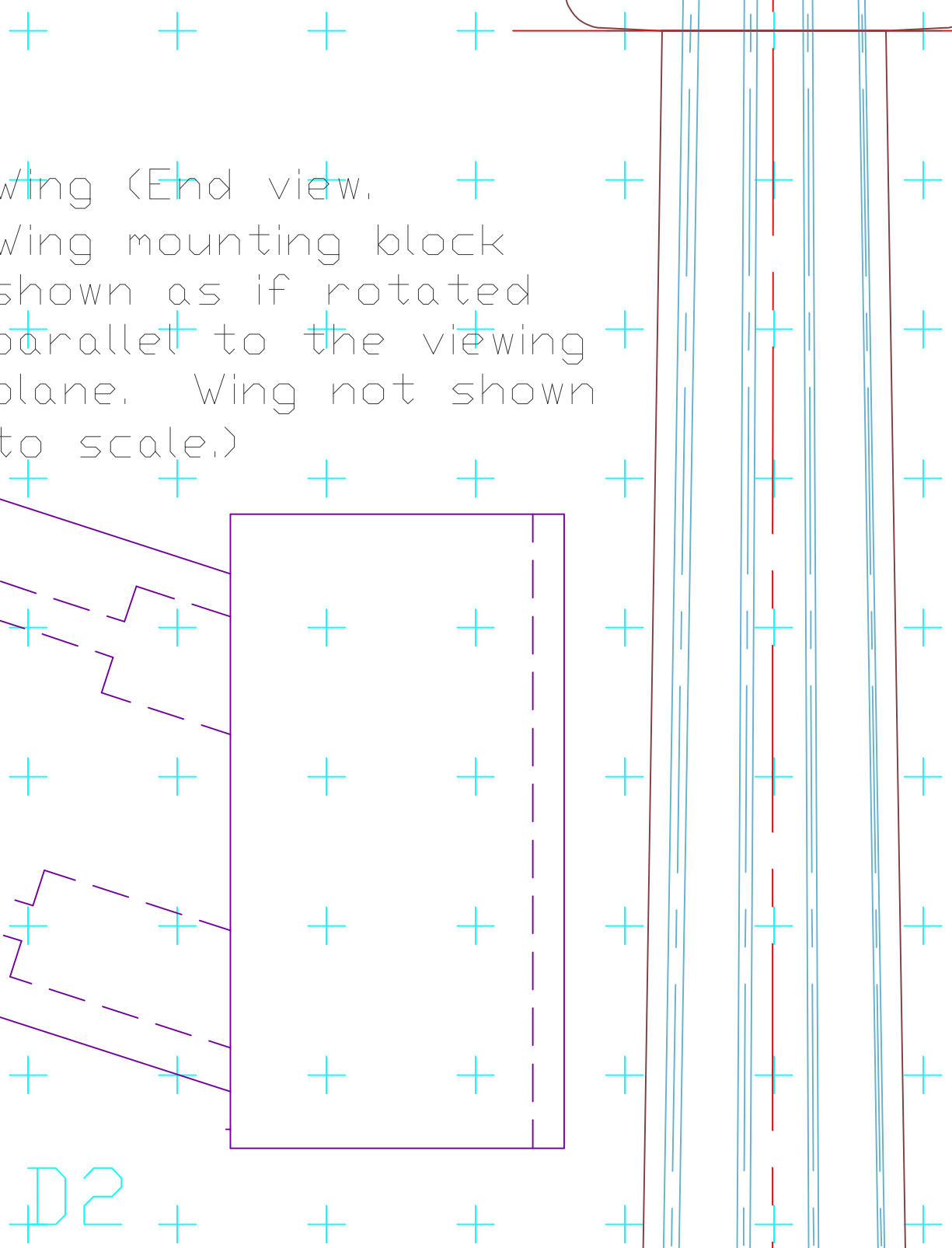
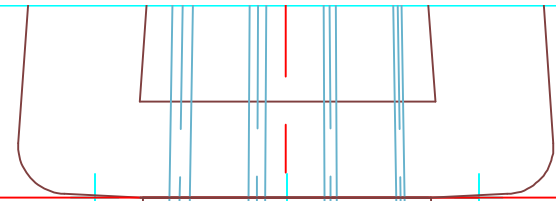

1. Front view of wing shows dimensions before it is bent.
2. Dimensions of wing in top and end views are approximate.
3. Wing attaches to back of body with $1/4"-20 \times 50$ mm connector bolts.
4. Strap buttons on wing are threaded 10-32 and attached with 10-32 machine screws.
5. String anchors are $3/16"$ drill stop collars. Mounting holes are drilled to fit their outside diameter.

+ + + + + + +
+ + + + + + +
D3 + + + + + + +

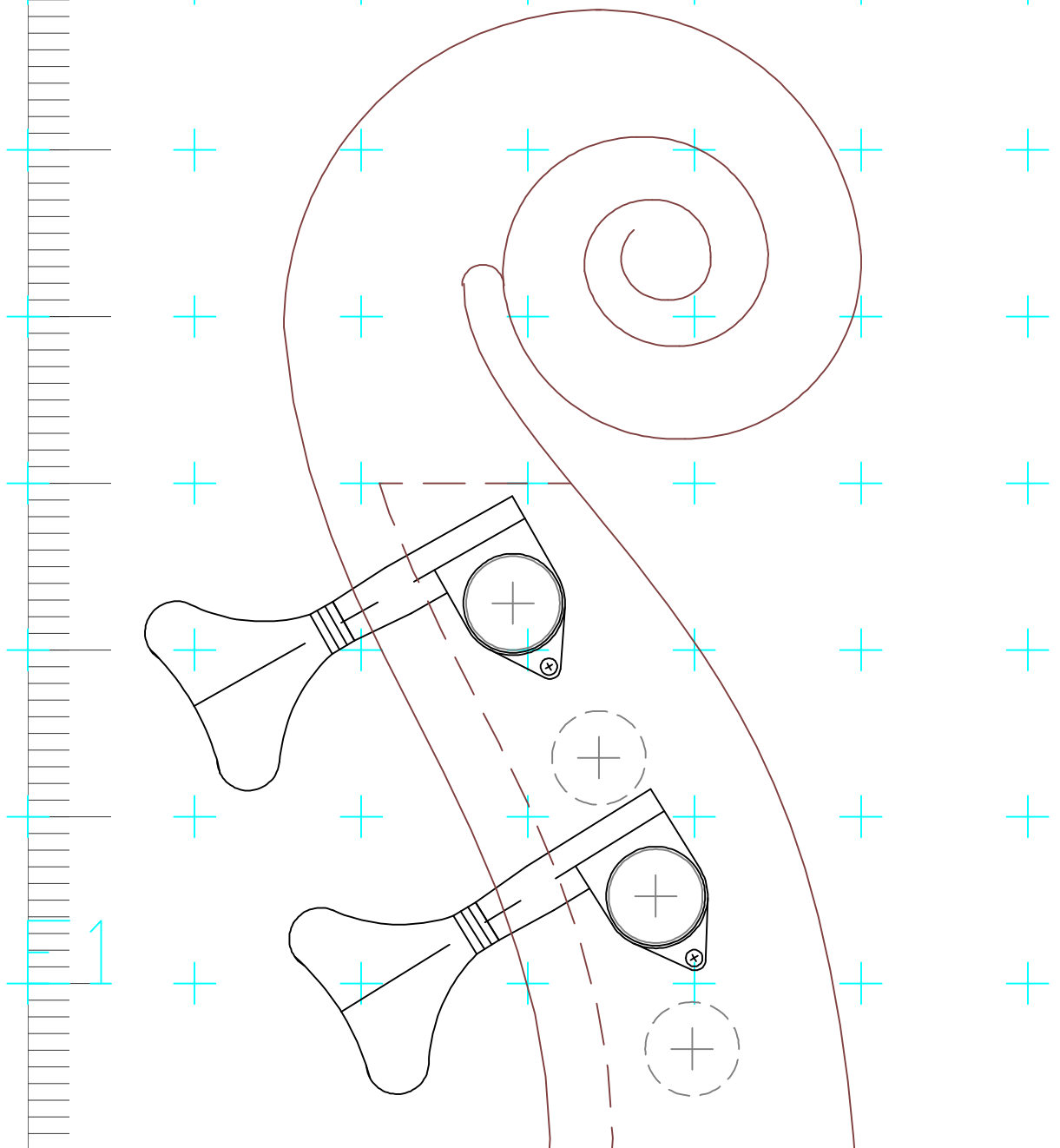

+ + + + + + +

+ + + + + + +

+ + + + + + +

+ + + + + + +

+ + + + + + +

+ + + + + + +

+ + + + + + +

+ + + + + + +

F2 + + + + +

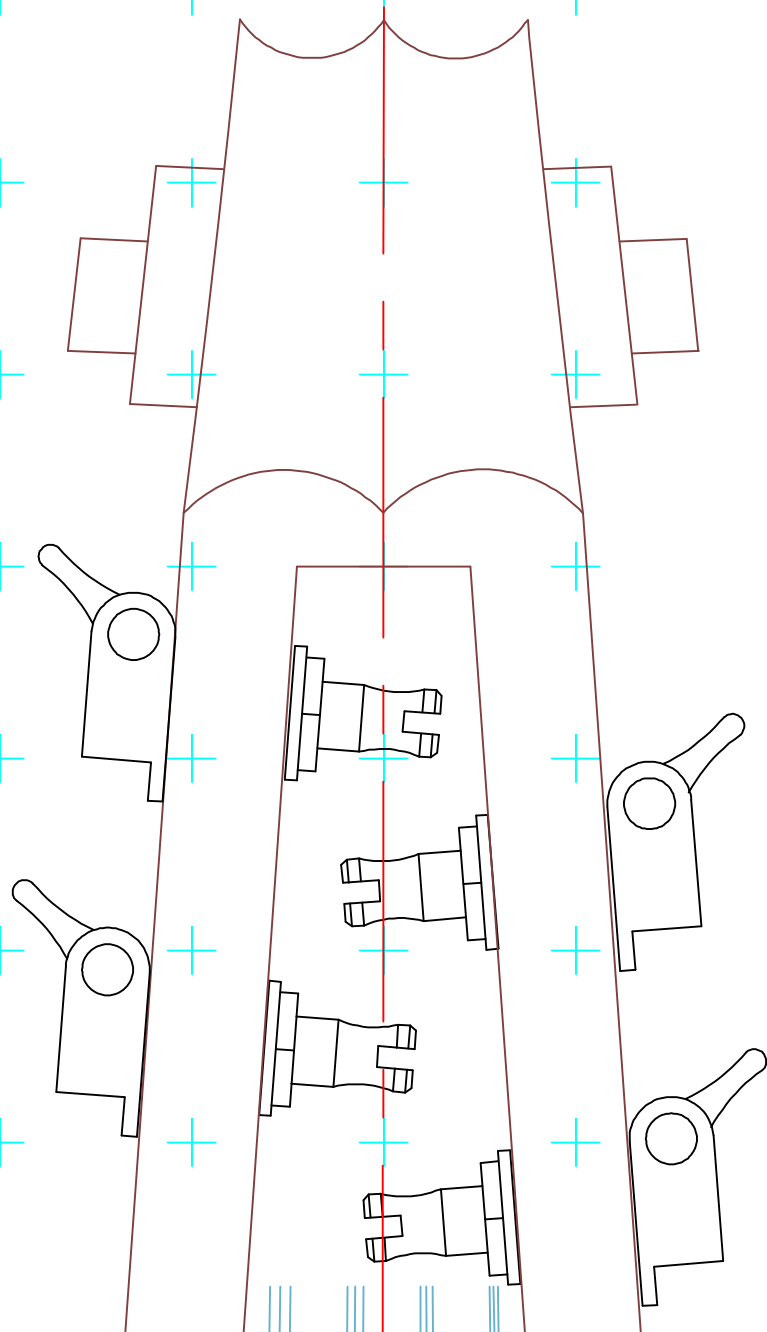

liutaio
Mottola
stringed instrument design

<http://www.LiutaioMottola.com>

Title:

Libellula Electric Upright Bass 35"

Drawn by:

RMM

Date:

1/15/05

Size:

24
×
48

Layers This Sheet:

Battery Box

Hardware

Border

Reference Lines

Print Grid

Electronic Parts

Dimensions

Cover

Neck

Body

Notes

Bridge

Cavity

Strings

Titleblock

Wings

Scale:

1:1

Sheet

1

of

1

Copyright (c) 2005 by R.M. Mottola All Rights Reserved

NOTES: